



Vertical weld overlay solutions

PolyClad C&B Column & boom and flatbed turntable



► Advantages

- Ease of setup
- Compact, modular standard design
- Versatility: vertical and all other weld overlay positions
- Two possibilities of cross slide mounting (front or side mounted)
- Delivered with a library of typical weld overlay programmes
- Flexibility: wide range of lances and torches
- Multiprocesses:   

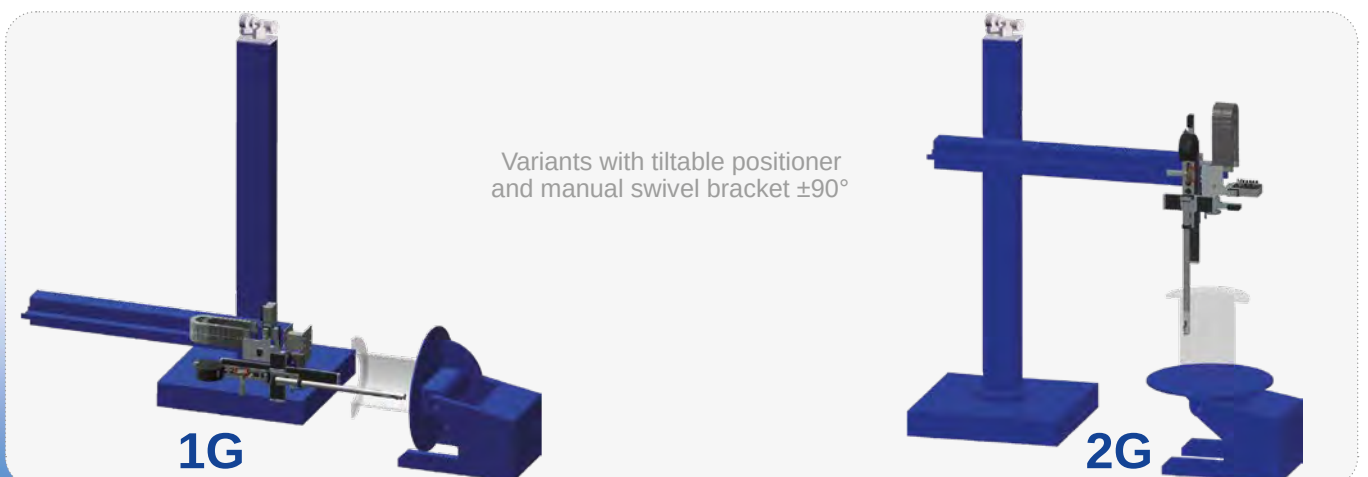
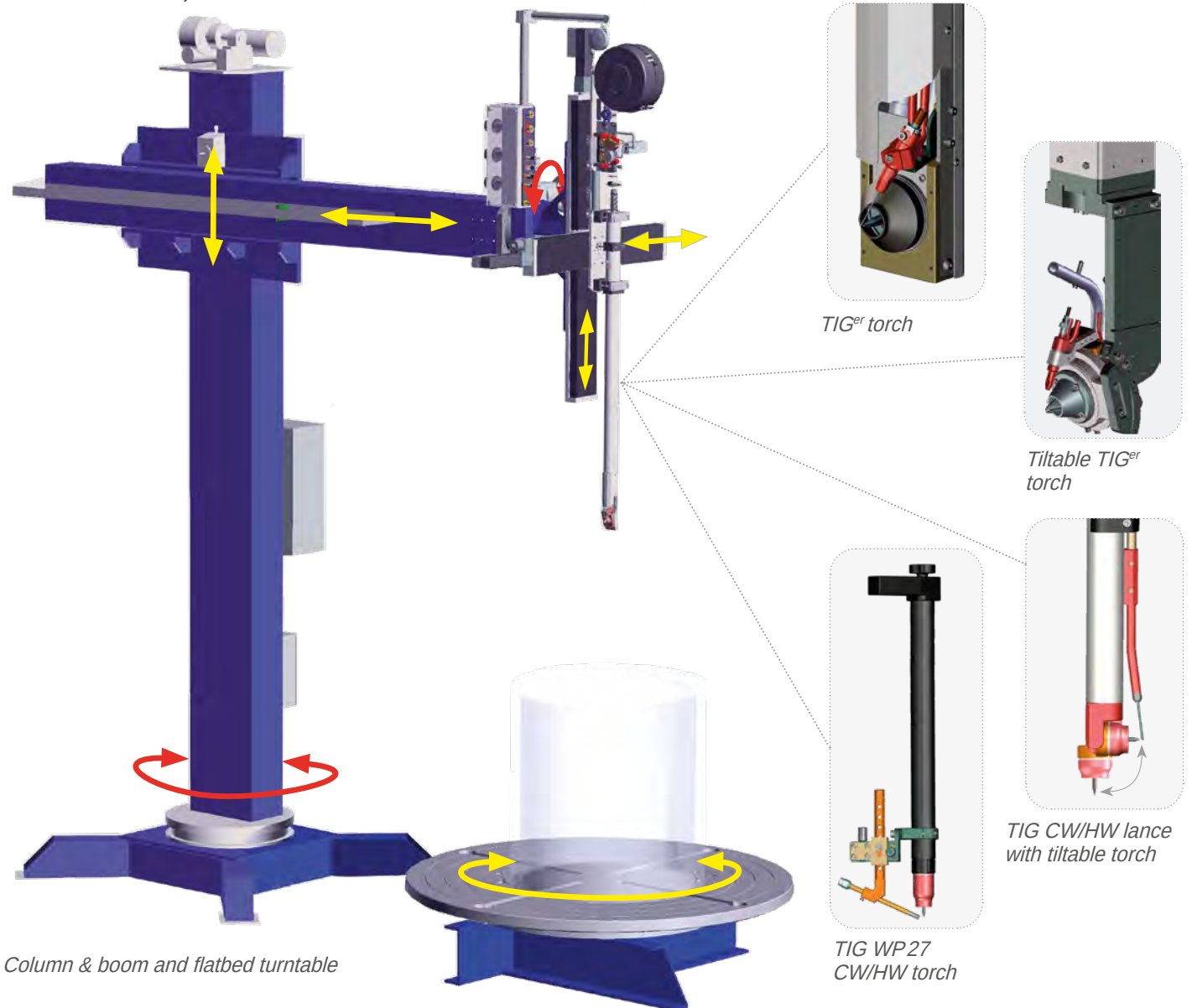

► Programming software

Two solutions depending on the workpieces complexity to be clad:

► Main items

- Column and boom
- Cross slides
- Wire feeder
- Lance/torch
- Flatbed turntable
- Smart welding station

► Variants / options - accessories

- High resolution video monitoring
- Tilttable positioner
- TIG HW or TIG^{er}
- Manual swivel bracket $\pm 90^\circ$ (cross slide tilting)
- High temperature bellows
- Systems Control Centre (◆)
- DAQbox - tool for productivity management and data acquisition

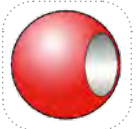
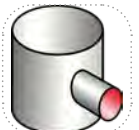
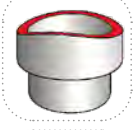
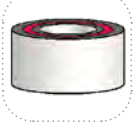
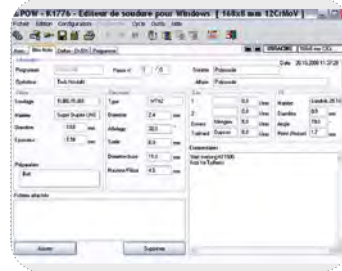

► Technical data

Column & boom	3 m x 2 m
Maximum height under boom	3 m
Vertical stroke (max.)	2 m
Horizontal stroke (max.)	2 m
Maximum load on boom end	150 kg
Cross slides stroke	1 m x 0.6 m
Wire feeder	0.5 to 14m/min
Compatible with wire spool	Ø300 mm - 15 kg
Capacity of the flatbed turntable	3t - Ø1.5 m
Capacity of the positioner	2t - Ø1 m
Maximum length of weld overlay lance	1 m

Other sizes of C&B, flatbed turntable and positioner are available on request

► Layout and utilities

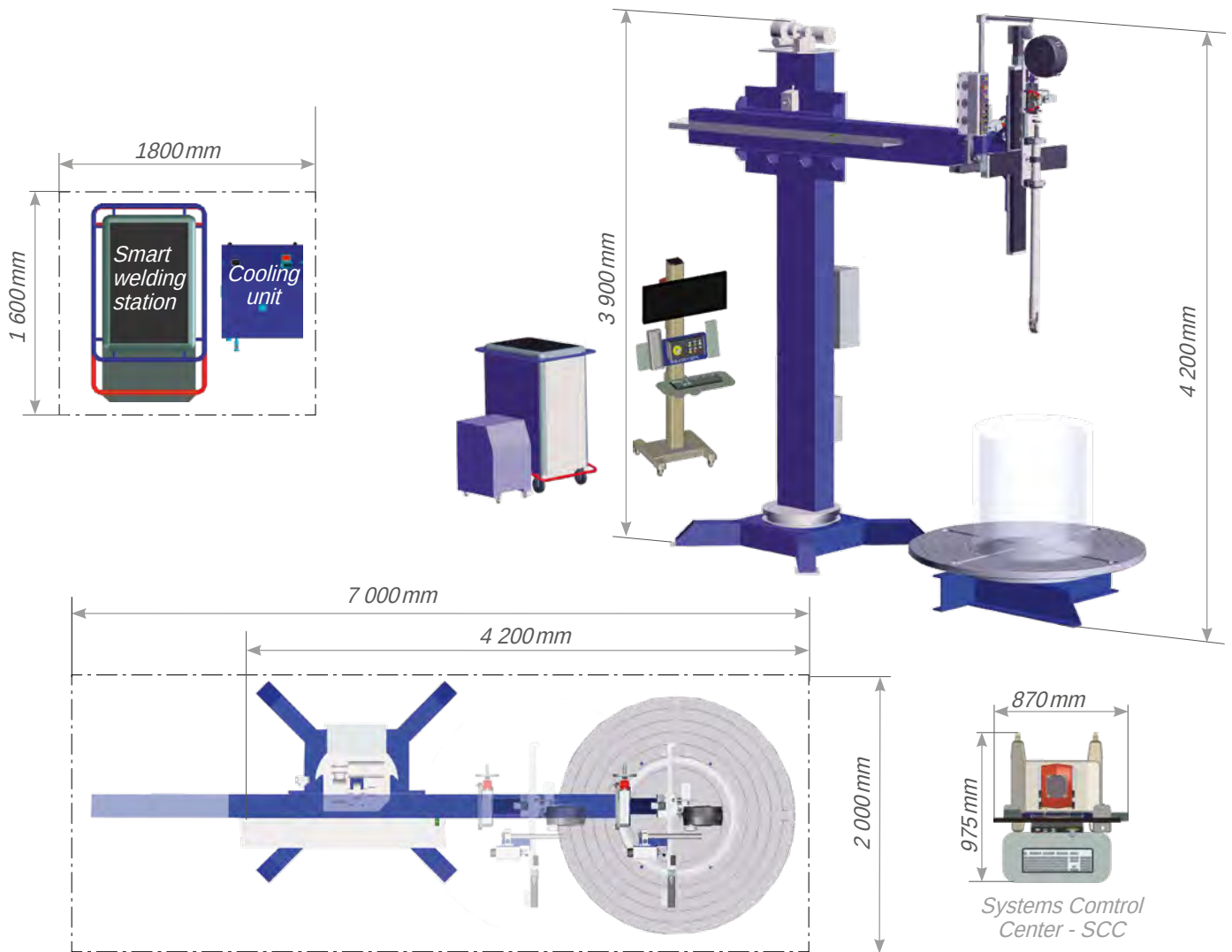

Utilities	
C&B with flatbed turntable/positioner	400 V - three-phase - 24 kVA
Smart welding stations - TIG CW/HW	400 V - three-phase - 33 kVA
Video container or SCC	230 V - single phase - 6 kVA
Cooling unit	230 V - single phase - 4 kVA

► Product item numbers

	TIG POW _{in}	TIG POW _{in}	TIG CNC	TIG CNC
PolyClad C&B - Standard vertical weld overlay installation (including C&B, cross slides, wire feeder, smart welding station and cooling unit)	0033260002	0033260003	On request	On request
Flatbed turntable 3t	0038002002			
Tiltable positioner 2t	0038001506			
Manual swivel bracket ±90° for cross slides	0033260101			
Digital display set for torch position and step-over (including digital display, torch slide encoder, position counter and cable)	0033842401			
Systems Control Centre	On request			
DAQbox - Data acquisition system	0033249101			
High temperature bellows for cross slides	0033380580			
Torches and lances	See Torches and lances on page 39			
Video system (optional)	On request			