

Parts List

- | | |
|---|--|
| 1. Base | 19. Thrust Bearing Housing Washer |
| 2. Gear Guard | 20. Knurled Nut (Left Hand Thread) |
| 3. Handle | 21. Bottom Cutter Support Bearing |
| 4. Top Cutter Lifter Cam | 22. Thrust Bearing Spindle Lock Nuts (Pair) 0.375" – 24 THDS |
| 5. Index Plate | 23. Bottom Shaft Lock Nuts (Pair) 0.750" – 13 THDS |
| 6. Spacer | 24. Bottom Shaft with Bevel Shaft |
| 7. Thrust Bearing Housing | 25. Bevel Gear for Bottom Shaft |
| 8. Spindle for Centre Bar | 26. Adjusting Screw for Depth of Top Cam with Locknut |
| 9. Washer for Centre Bar Spindle | |
| 10. Top Shaft | |
| 11. Tee Screw | |
| 12. Thrust Bearing | |
| 13. Centre Bar Complete (Standard) | |
| 14. Bottom Cutter (Geared) | |
| 15a. Top Cutting Disc for Sheet Metal | |
| 15b. Top Cutting Disc for Non-Metallic Material | |
| 16. Spur Gear – For Top or Bottom Shaft | |
| 17. Thrust Bearing Lock Nut | |
| 18. Top Cutter Lifter Bearing | |

Parts Not Shown

- Extension Bars: #13A – Medium Bar 28.000" – 54.00"
 #13B – Long Bar 54.000" – 80.000"
#27 Spanner Wrench
Set of Cutters: #28 – For Sheet Metal
 #29 – For Non-Sheet Metal

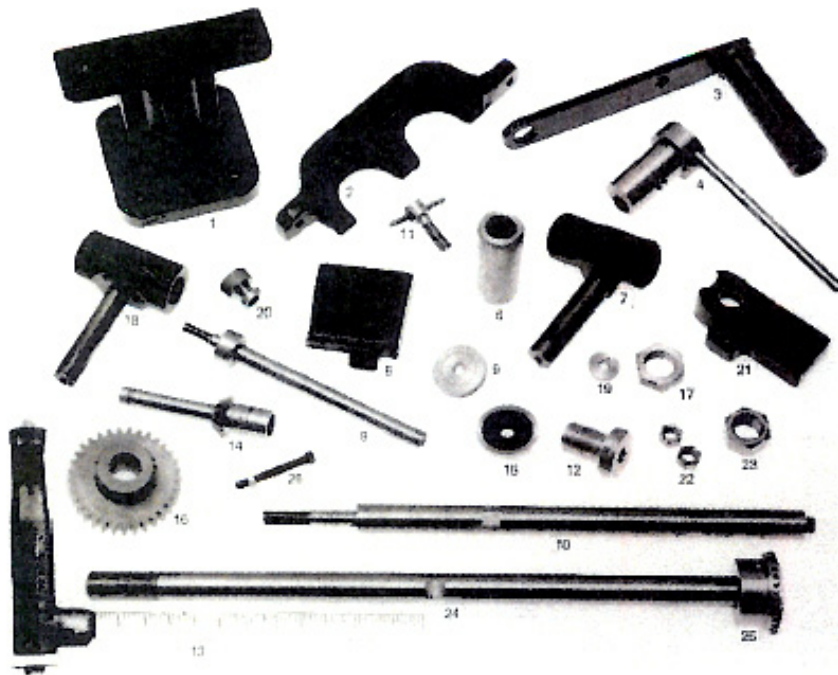

DISTRIBUTED BY: